



User Manual



Model: H7090

RGBIC Car LED Strip Lights

Safety Instructions

Read and follow all the safety instructions:

- Be cautious of static electricity during installation and usage. Keep the product away from sharp objects or strong corrosive chemicals.
- When bending the strip lights during installation, avoid folding the LED components as it may affect the product's life span.
- Remove nails, metal, or other conductive objects from the installation surface before attaching the strip light, as it may cause short-circuiting.
- Do not install the strip lights near any heat sources.
- Do not allow children to install the strip lights alone.

Introduction

Thank you for choosing Govee RGBIC LED Interior Car Lights. This product is an interior car light and supports app control. RGBIC is Govee's latest lighting display technology. With its advanced IC chips (independent control), each strip light segment can be adjusted independently, creating vibrant rainbow effects.

What You Get

LED Strip Lights	4
Car Cigarette Lighter	1
User Manual	1
Service Card	1

At a Glance

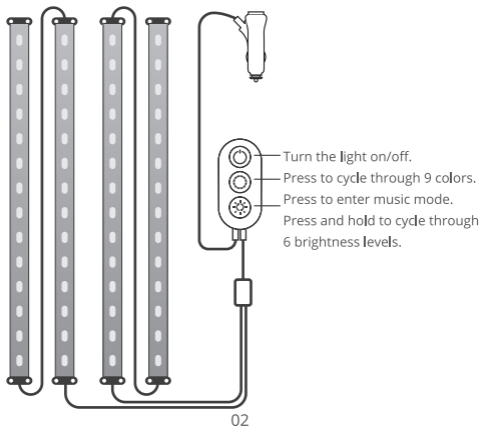

Installing Your Device

Before You Install

- 1 Unpack the box and check all items listed in the packing list.
- 2 Power on the strip light and check whether it lights up.

Installing Steps

- 1 Wipe the surface to keep it clean and dry.
- 2 Install the cigarette lighter and control box in the central console.
- 3 Peel off the protective film and stick the strip lights as indicated in the picture.
- 4 Firmly press the strip from end to end and reinforce ends of the strip with zip ties and screws.
- 5 Insert the cigarette lighter into the outlet and press the button on it. The button will light on, indicating the strip light is powered on.

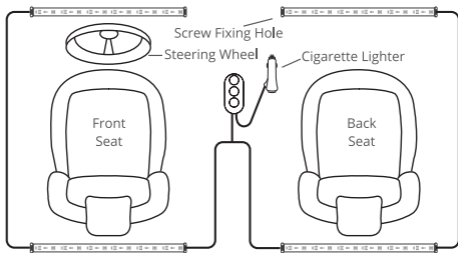

Pairing Your Device with the Govee Home App

What You Need

- A smartphone or tablet running iOS 8.0 (or above) or Android 4.3 (or above).

Pairing Instructions

- 1 Download the Govee Home app from the App Store (iOS devices) or Google Play (Android devices).
- 2 Turn on Bluetooth on your smartphone.
- 3 Open the app, tap the “+” icon in the top right corner and search for “H7090”.
- 4 Tap the device icon and follow the on-screen instructions to complete pairing.



Specifications

Length	4x30cm /4x0.98ft
Light Color	RGBIC
Power Supply	Car Cigarette Lighter
Control Method	App, Control Box
Voltage	12V

Troubleshooting

- ❶ The adhesive tape is not strong enough.
 - Make sure the installation surface is clean and dry.
 - Firmly press over the strip after sticking.
 - Reinforce the installation with more clips and tape.
- ❷ Cannot connect to Bluetooth.
 - Do not skip Bluetooth connection in the app.
 - Ensure Bluetooth on your smartphone has been turned on.
 - Your smartphone may be incompatible with the Govee Home app. Try using a different smartphone then reconnect.
 - Power the strip lights and your smartphone Bluetooth off then on, then try again.

- Ensure that your smartphone is within 1 m/3.28ft of the strip lights when connecting.
 - Clear any obstructions that are between the strip lights and your smartphone.
- ③ The strip lights does not display the full selected color/Some LED beads do not light up.
- Please contact the Govee support team for rapid product replacement.
- ④ Cannot sync the strip lights to the beat of my music.
- Move the control box closer to the music source.
 - Clean the mic on the control box then try again.
- ⑤ The LED strip doesn't turn on.
- Please make sure the cigarette lighter is well connected with power plug.
 - There is a button on the cigarette lighter. Please make sure it is pressed and turns red. It is indicated that the strip lights are powered.

Customer Service

 Warranty: 12-Month Limited Warranty

 Support: Lifetime Technical Support

 Email: support@govee.com

 Official Website: www.govee.com

 @Govee  @govee_official  @govee.official

 @Goveeofficial  @Govee.smarthome



Govee Home App

For FAQs and more information,
please visit: www.govee.com