



Quick Start Guide

Model: H1069D

Govee Smart Mini Panel Lights Expansion Kit

Note

Before Installation:

- This expansion kit does not include power supply and control box, and please use with H6069/H8069 series products.
- Make sure to unplug the device from the power supply before you start the installation. The connecting pieces are easy to break, please handle them with care.
- Make sure a panel light is spliced with the previous one using a connecting piece, no need to form a closed loop of the circuit.

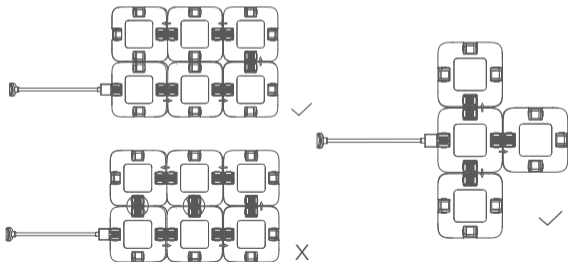

- Try to splice the lights on the desk or ground first and install them on the wall once you have calibrated and confirmed the shape design via the app.
- Clean and ensure the surface is totally dry before installing the product.

During Installation:

- Connecting the Panel Light and Power Supply: Pre-install the connecting piece into the next splicing direction first, and then press the power supply terminal into the panel light.

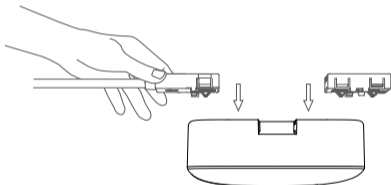

- **Connecting Panel Lights:** Install a connecting piece into the next splicing direction, and press the panel light to the connecting piece of another panel light.

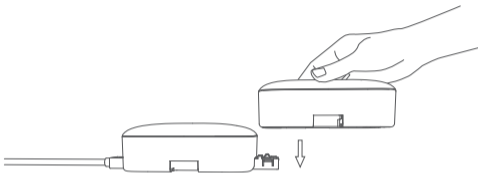

- **Remove:** If you want to remove a panel light from your spliced shape, press and hold its neighboring lights and take it out vertically.

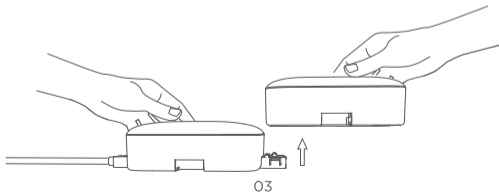

- A single power adapter can only support up to 70 panel lights. If you have any other needs, please contact customer service.

After Installation:

1. Follow the in-app instructions to complete calibration.
2. If the recognized shape in Govee Home App does not match your actual design or the light sections are not lit, check the connecting part between the light and the power source or between the lights. Then enter the control page to calibrate the lights with the "Layout & Calibration" function. If the issue still exists, please contact customer service.



Govee Home App

For FAQs and more information,
please visit: www.govee.com